

BEFORE YOU START PLEASE READ INSTRUCTIONS CAREFULLY

- Check the pack and make sure you have all the parts listed.
- When you are ready to start, make sure you have the right tools at hand (**not supplied**) including a Phillips screwdriver, Stanley knife, wood saw, step ladder and drill with 2mm bit.
- Ensure there is plenty of space and a clean dry area for assembly.

TIMBER

As with all natural materials, timber can be affected during various weather conditions. For the duration of heavy or extended periods of rain, swelling of the wood panels may occur. Warping of the wood may also occur during excessive dry spells due to an interior moisture loss. Unfortunately, these processes cannot be avoided but can be helped. It is suggested that the outdoor building is sprayed with water during extended periods of warm sunshine and sheltered as much as possible during rain or snow.

Our buildings are delivered pre-treated with a water based timber treatment however this only helps to protect during transit of your garden item. **To validate your guarantee and for better protection against weathering it is ESSENTIAL** that you treat the garden building with a wood preserver within 3 months of assembly. This will need to be re-applied annually to ensure longevity of your building. Care must be taken when constructing the garden building that it is not touching the ground and is on a suitable base.

BUILDING A BASE

When thinking about where the building and base is going to be constructed: Ensure that there will be access to all sides for maintenance work and annual treatment.

TYPES OF BASE

- Concrete 75mm laid on top of 75mm hard-core.
- Slabs laid on 50mm of sharp sand.

Ensure the base is level and is built on firm ground, to prevent distortion. Refer to diagrams for the base dimensions, The base should be slightly smaller than the external measurement of the building, i.e. The cladding should overlap the base, creating a run off for water. It is also recommended that the floor be at least 25mm above the surrounding ground level to avoid flooding.

Whilst all products manufactured are made to the highest standards of Safety and in the case of childrens products independently tested to EN71 level, we cannot accept responsibility for your safety whilst erecting or using this product.

x2 This building should be erected by two people.

2mm Drill bit For ease of assembly, it is advisable to pilot drill all screw holes and ensure all screw heads are countersunk.

Winter = High Moisture = Expansion
Summer = Low Moisture = Contraction

For Assistance Please Contact Customer Care on 01636 880514

Building content

8x8 Helios

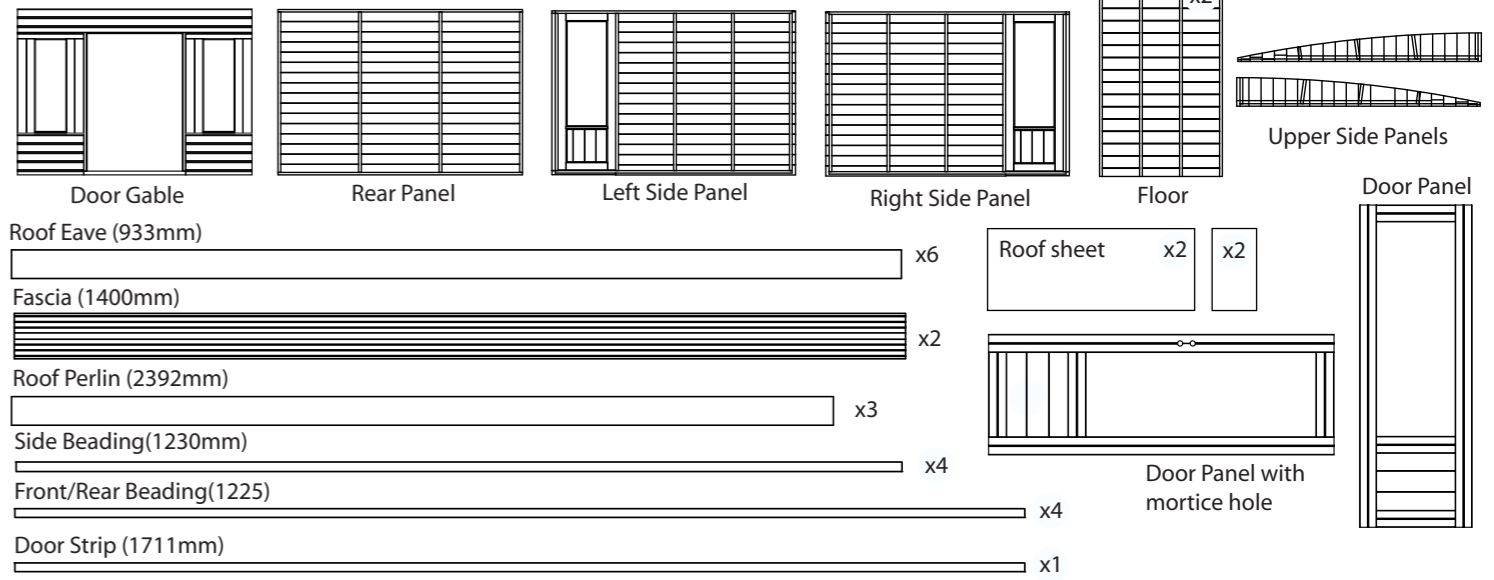

10x8 Helios

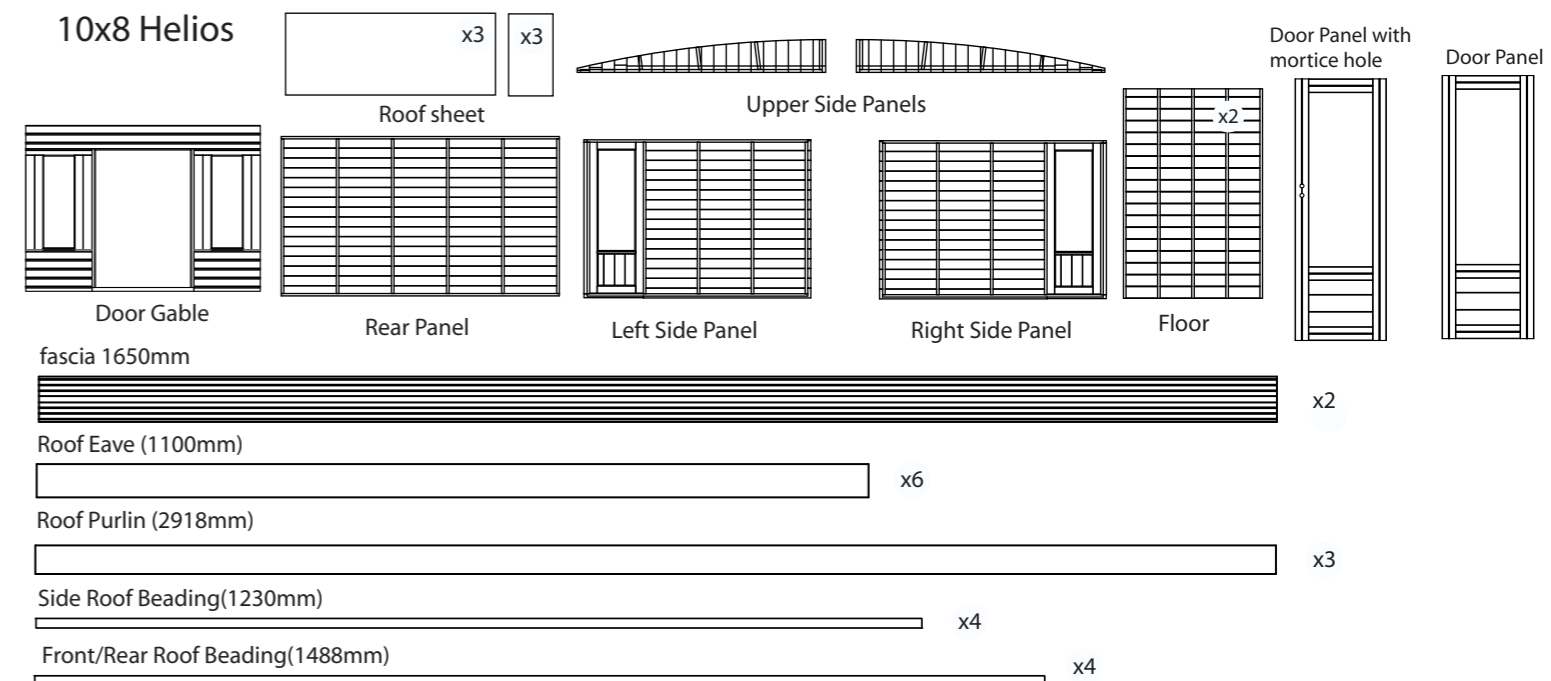

Corner Trims

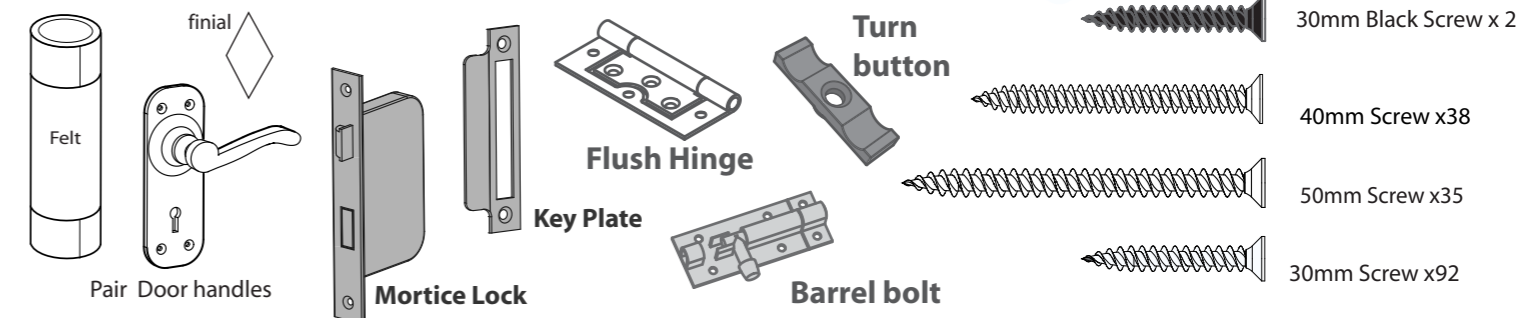
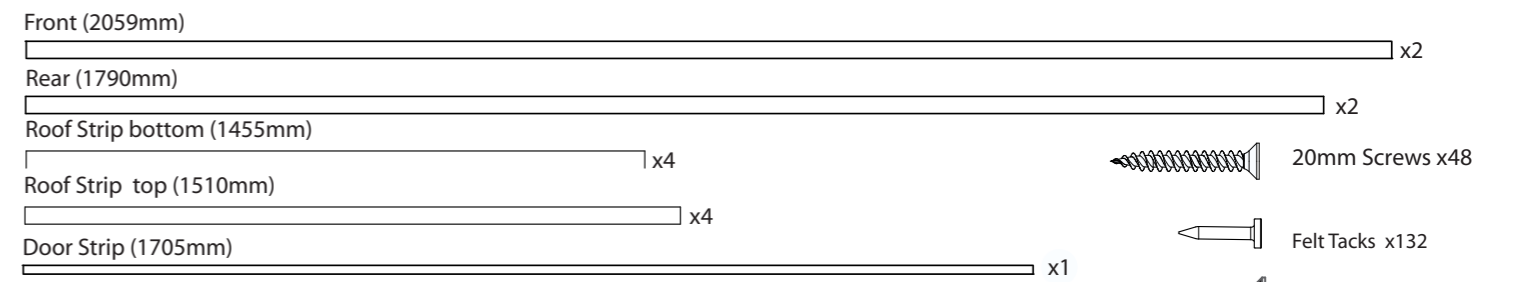

Door Fixings

- i** Join the hinge to the door frames with 30mm screws making sure to use the outer plate of the hinge.

6x30mm Screws

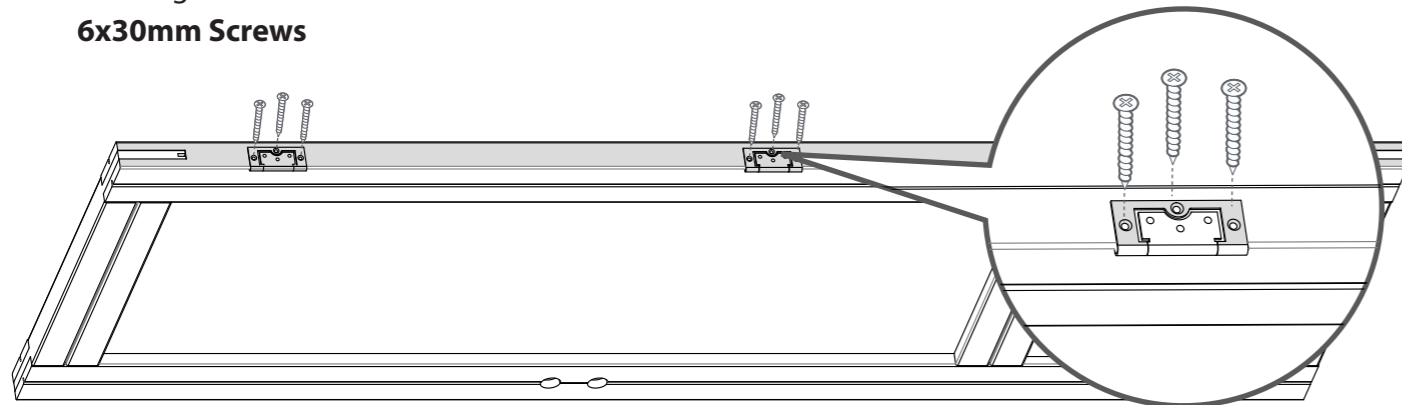

- ii** Join the hinge to the front panel with 30mm screws making sure to use the inner plate of the hinge.

9x30mm Screws

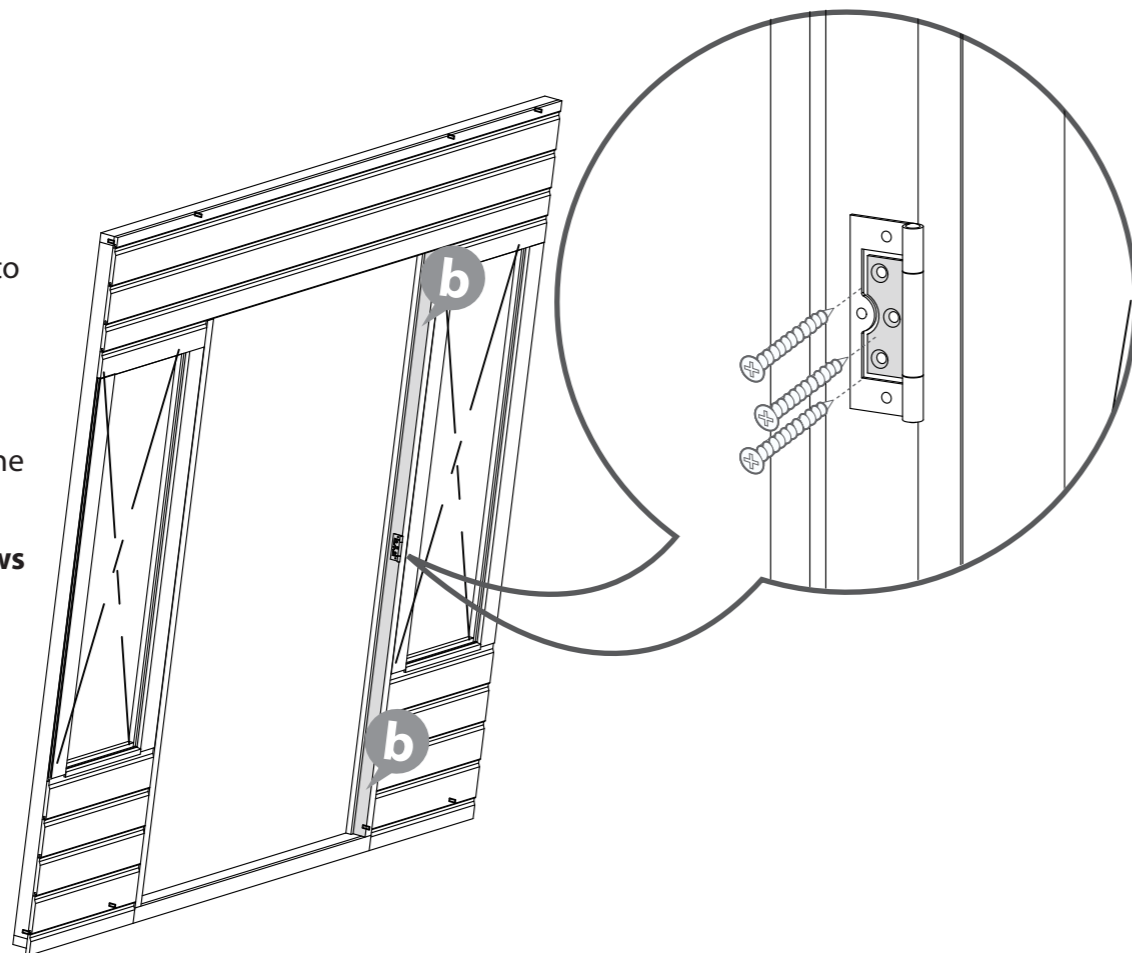

Fit the mortice lock into the recess and fix in place with the screws provided. Fit the key plate to the opposite door using the screws provided.

The Mortice Lock is Reversible

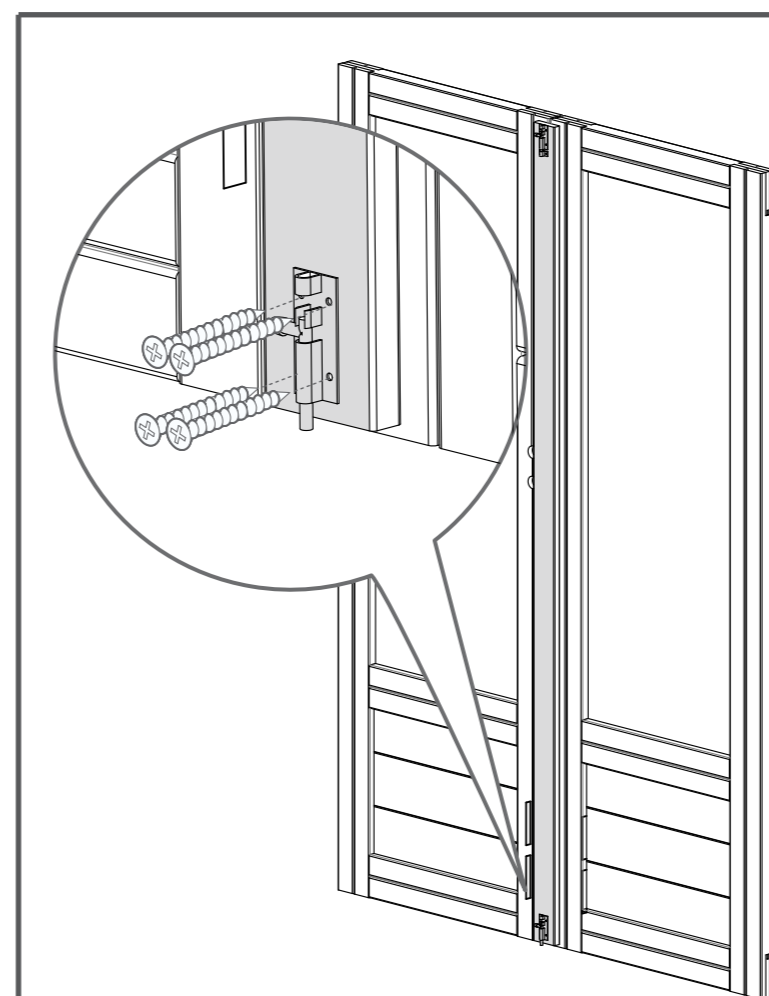
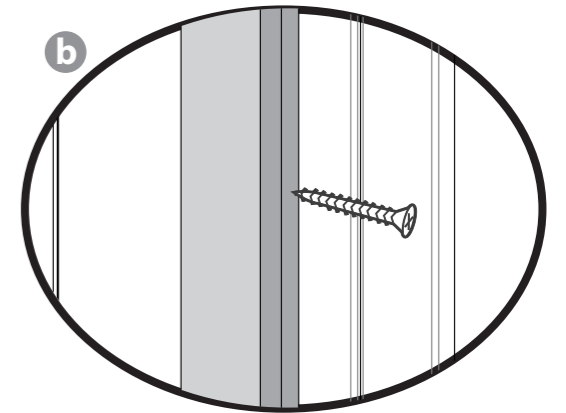
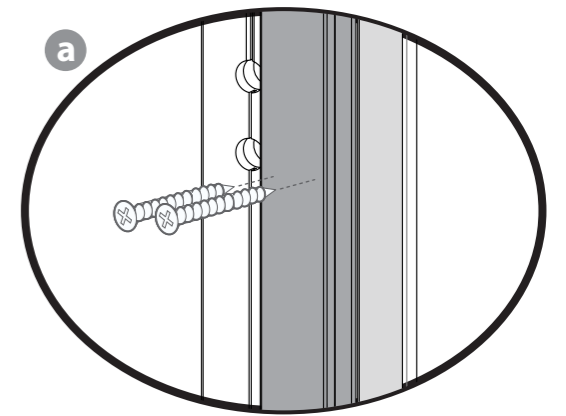
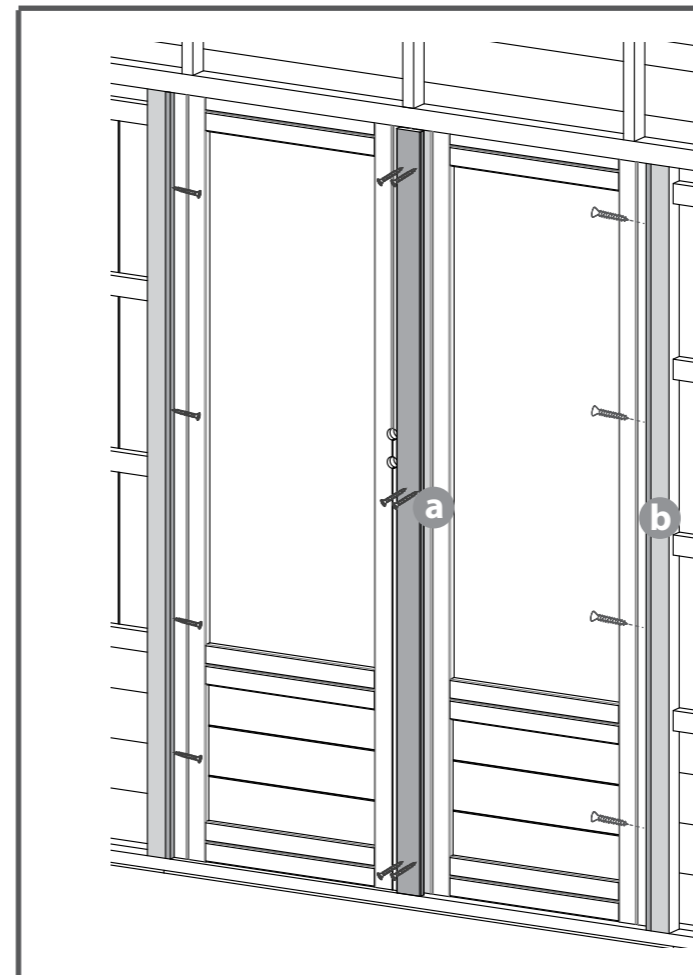
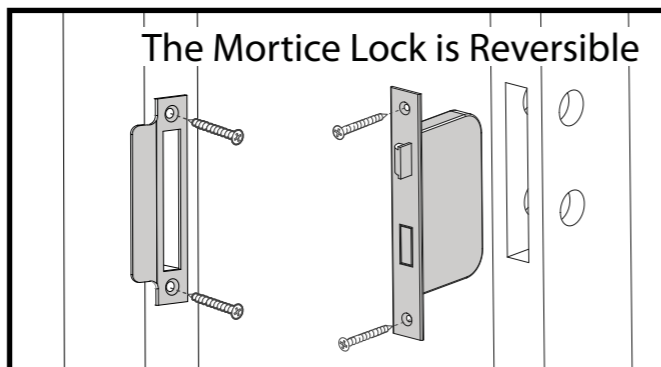

iii

- a** Fix the strip to the inside of the door that does not have a mortice hole (Slave Door), using 6x30mm screws as shown on the left.

6x30mm Screws

- b** When fitting each beading strip ensure that it sits flush with the door frame and door. Attach the beading to the door frame with 4x30mm Screws.

8x30mm Screws

iv

- Attach the Barrel Bolts to the strip fitted on the last step at the bottom and top of the doors.

8x30mm Screws

HANDY HINT

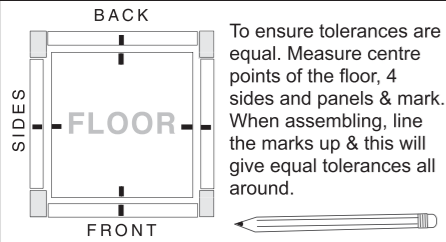

To ensure tolerances are equal. Measure centre points of the floor, 4 sides and panels & mark. When assembling, line the marks up & this will give equal tolerances all around.

FIXING METHODS

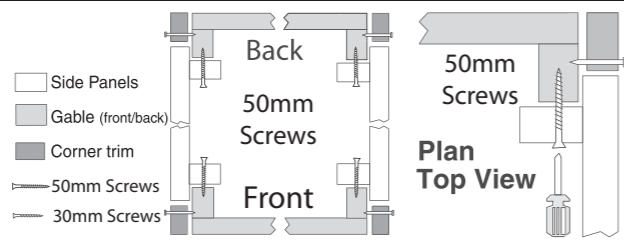

Remove Transportation Blocks

Remove transportation blocks from the bottom of each panel before beginning assembly.

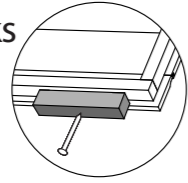

2 Panel Assembly

- a** Fix the corners with 3 x 50mm Screws as in diagram.
- b** Do not secure the building to the floor until the roof is fitted. Fix the panels to the floor with in alignment with the floor joists.

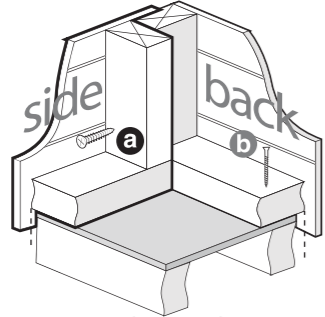

Position the panels so there is equal spacing in between the floor and the cladding on all 4 sides.

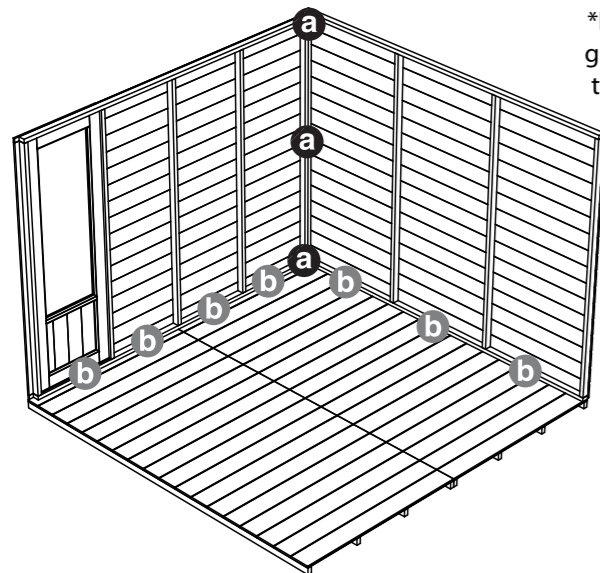

Position the rear gable onto the floor, the frame sits onto the floor with the T&G boards overlapping. Locate the side panel & rear gable frame to frame as in diagram.

*Do not secure the building to the floor until the roof is fitted.

*Important, Before fixing door gable, remove screws securing the doors from bottom of the panel

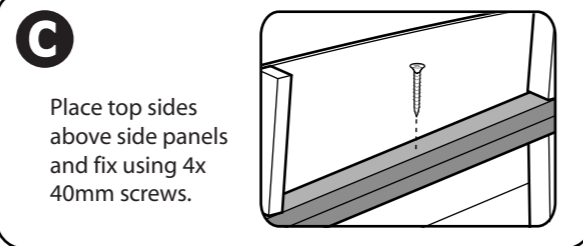

Place top sides above side panels and fix using 4x40mm screws.

Fix the door gable last, ensure the door is unlocked for access

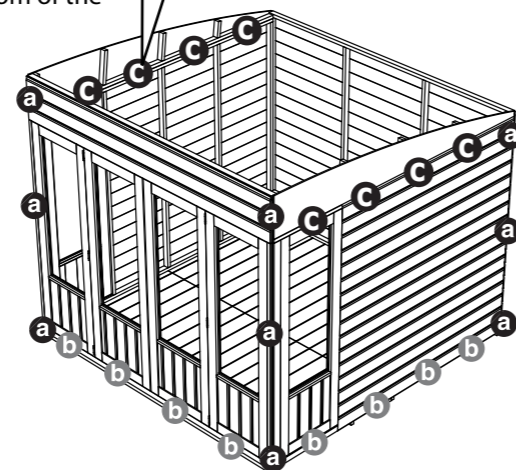

This building will distort if not erected on a firm and level base. Square the building to the floor, making sure the door and windows open.

8x40mm Screws
27x50mm screws

1 Floor Assembly

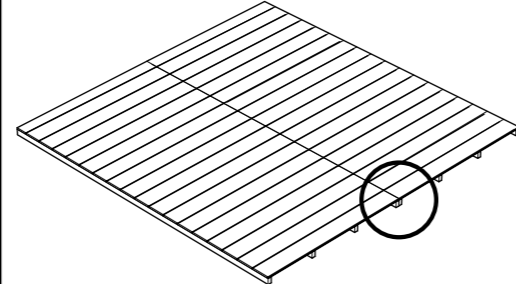

Position floor section a & b as in diagram so that floors are flush to each other, note that the floors do not connect by a T&G joint. Fix with 8x50mm screws alternate the fixing positions along the length of the floors

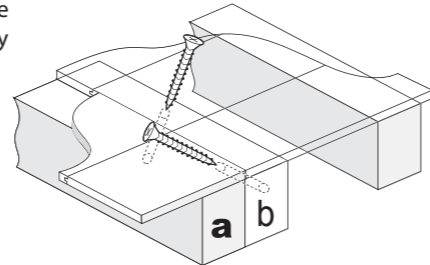

Door Handle

Fit the mortice lock into the recess and fix in place with the screws provided. Fit the key plate to the opposite door using the screws provided.

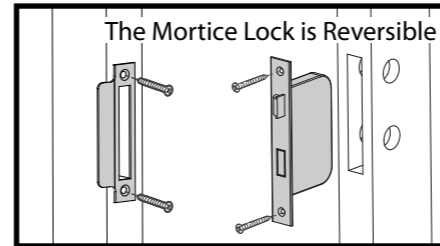

Fix Door handles and metal bar (spindle) using 8x30mm screws. Ensure Mortice lock closes correctly. If not remove lock and turn catch around using small grub screw.

8x30mm screws

3

4

Purlins

Fix Purlins to Upper side uprights, using 2x40mm screws for each purlin.

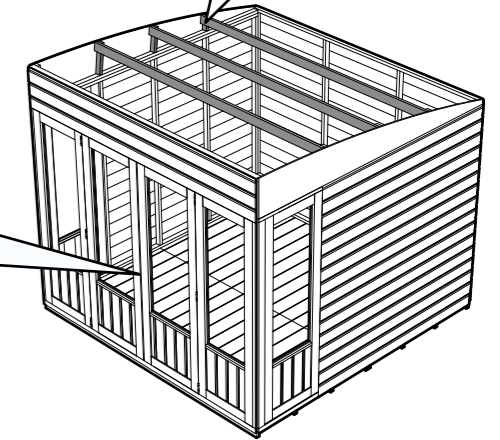
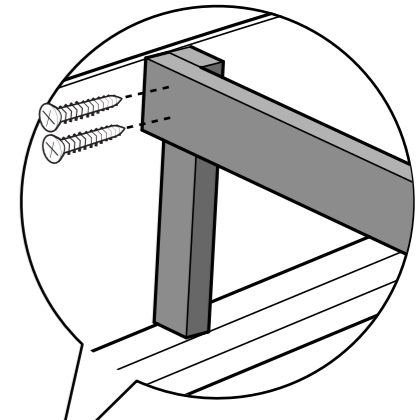

12x40mm screws

1 Fix the roof eaves to the roof sheet with 6 x 30mm screws per eave.

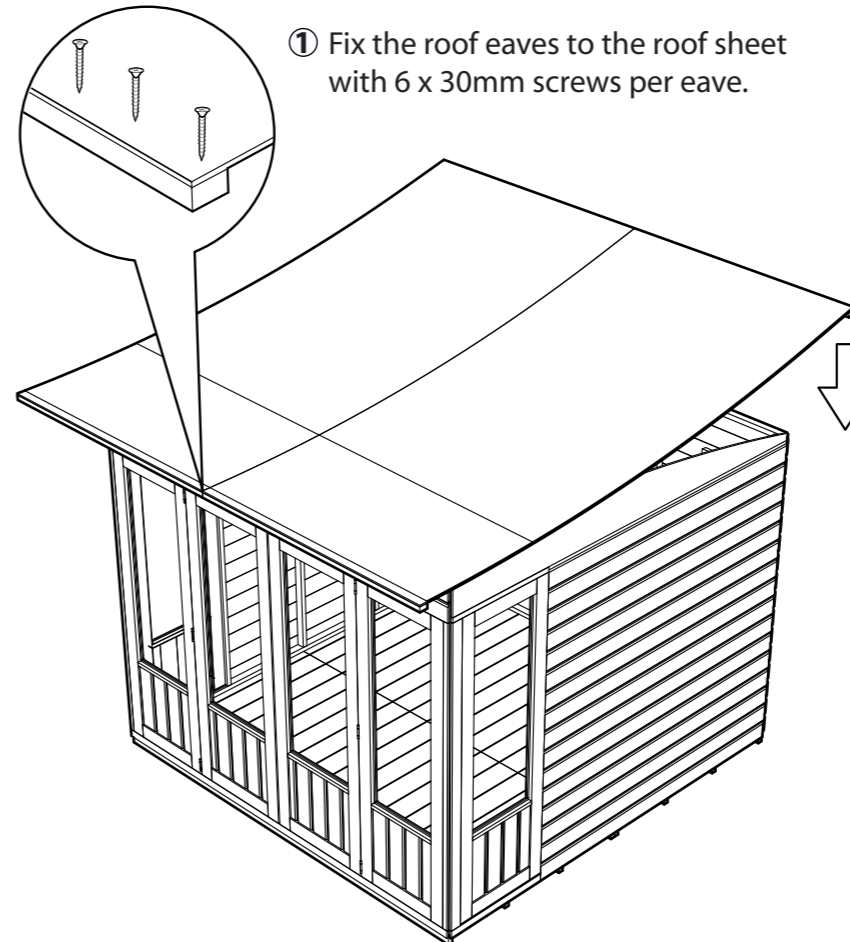

5 Roof Assembly

2 Position the roof sheets ensuring that the edge of the smaller sheet is half across the width of the first roof Purlin. Secure with 12x30mm screws across.

3 Fix roof sheets using 6x30mm screws across each purlin and along the upper side panel framing.

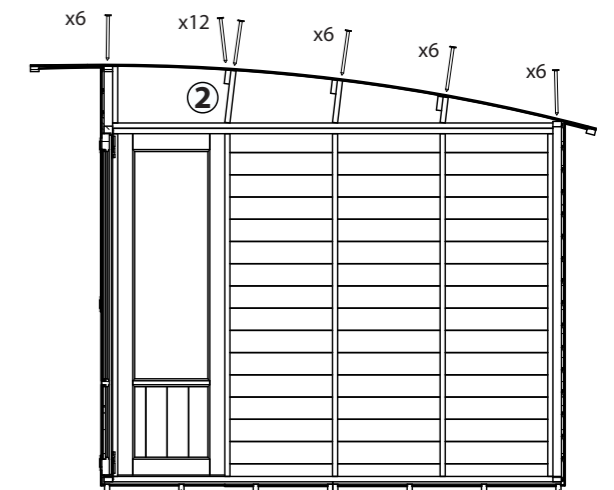

48x30mm screws

6

Felting

Roll felt across from side to side in order as indicated, leaving 50mm overlap to front and back and sides. Secure with felt tacks at 100mm intervals

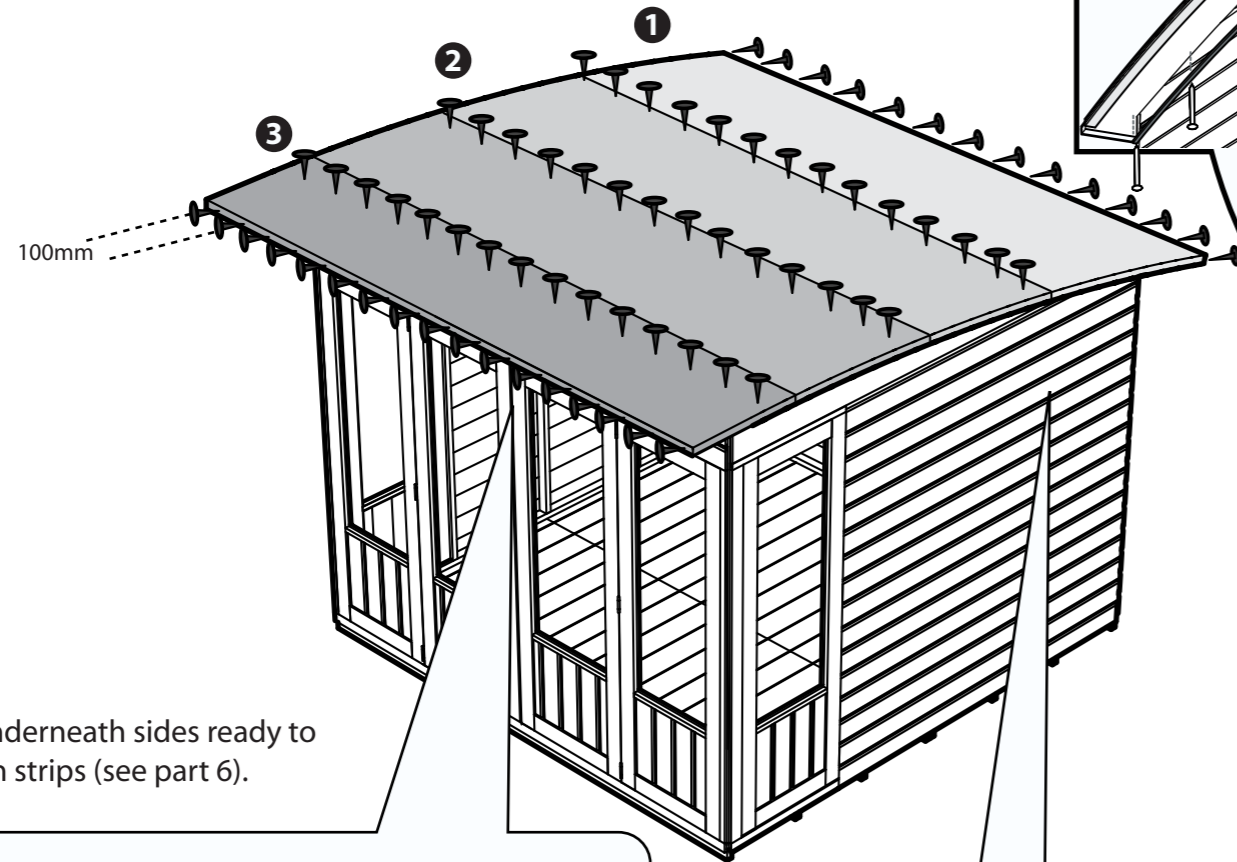

Fold felt underneath sides ready to secure with strips (see part 6).

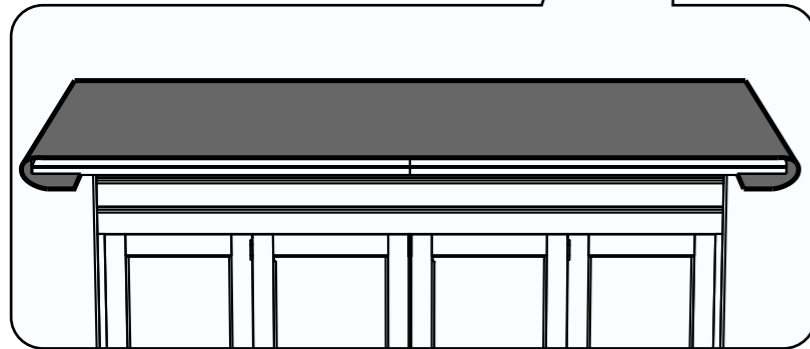

3x sheets of Felt

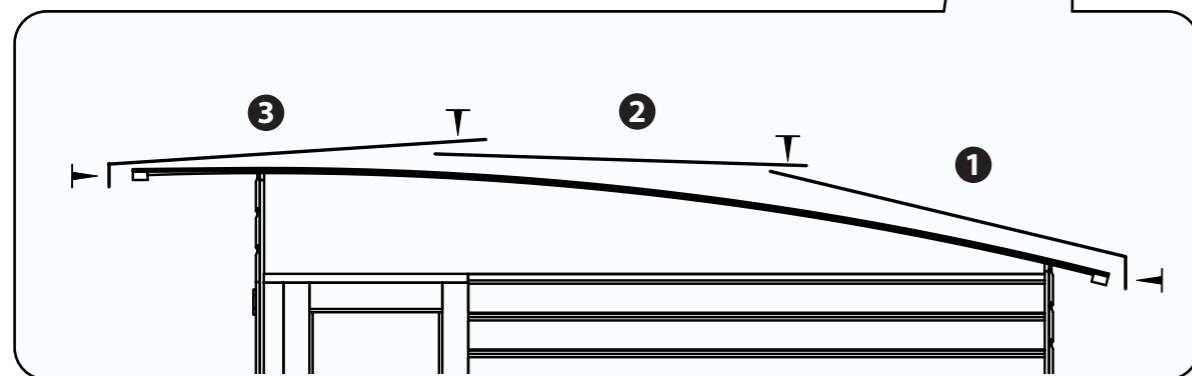

160 Felt tacks

7

Roof Strips

To secure roof, sandwich strips under and on top of each side overhang using 20mm screws.

Fix 2x roof beading per side underneath the roof where the gable top meets. Use 3 x 20mm screws per strip

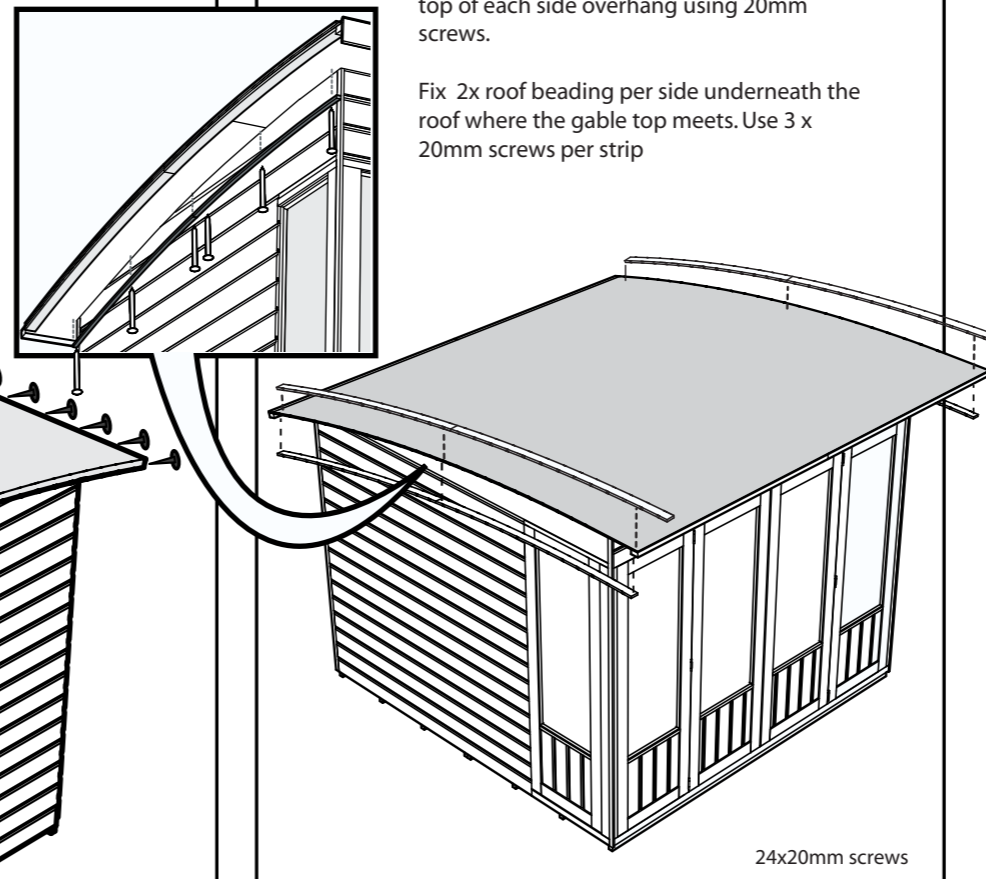

24x20mm screws

Roof Beading

Secure the beading to the underside of the roof using 3x20mm screws on the front and rear of the building

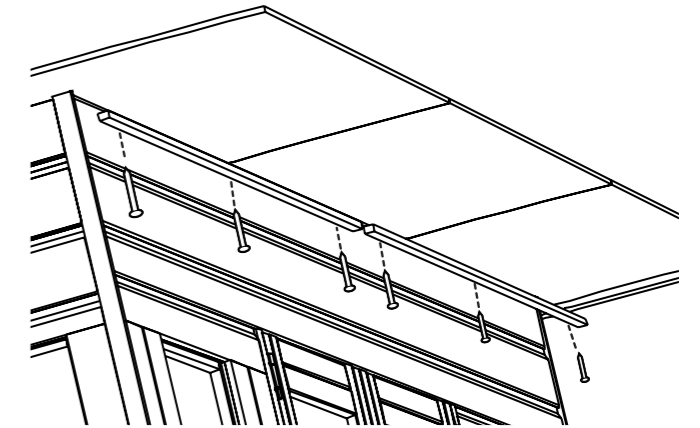

24x20mm screws

8**9**

Fascia Fixing

Fix Fascias with 4x 40mm screws in each piece, pre drill to avoid splitting. Locate screws in diagram, trapping felt in between.

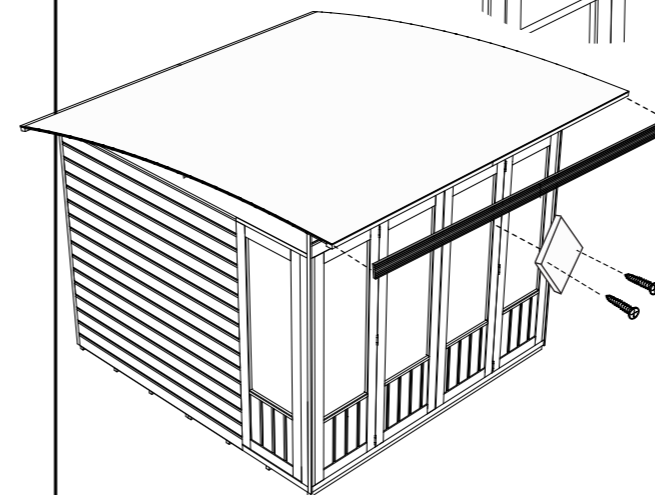
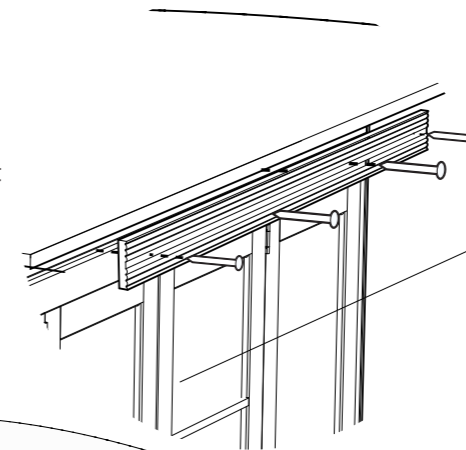

Using 2x40mm screws attach the finial to the centre of the fascia.

18x40mm screws

Corner trims **10**

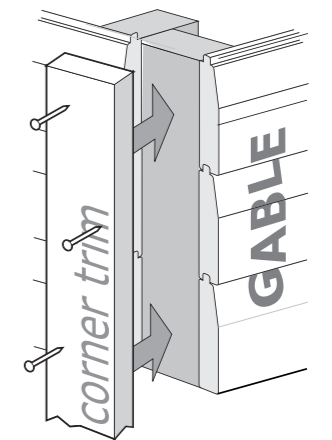

Please note corner / cover trims may need on site adjustment, cut with wood saw to appropriate size. Position corner trims level with bottom of building and fix with 3 x 30mm screws per corner. Position cover trims over joint where the two side sections meet and fix in same manner.

12x30mm screws

Door Turn Buttons

Attach two turn buttons to the slave door at the top and bottom of the door using black screws.

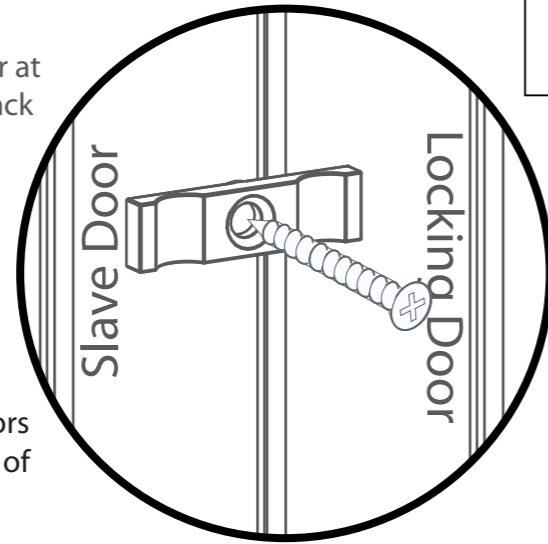

These turn buttons help to keep your doors straight during high levels and low levels of moisture content in the air.

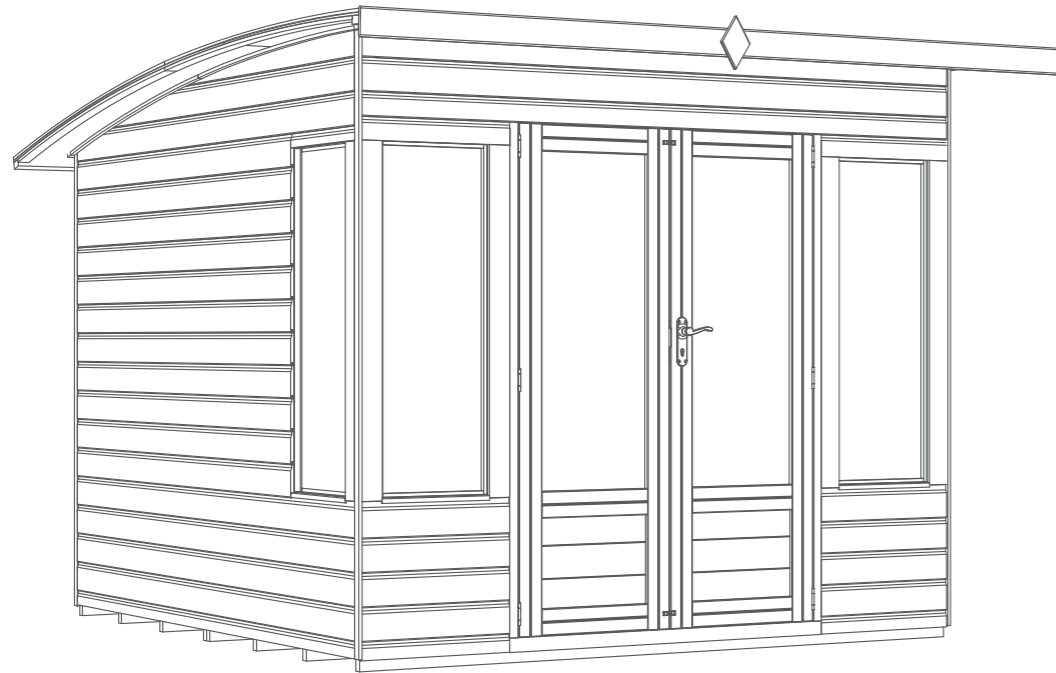

2x30mm Black screws

11